

WELCOME TO



Ourlow Beach
CAMP LEJEUNE, NC

MAP NOT TO SCALE

↑ TO SNEADS FERRY ROAD



INTRACOASTAL WATERWAY (ICW)

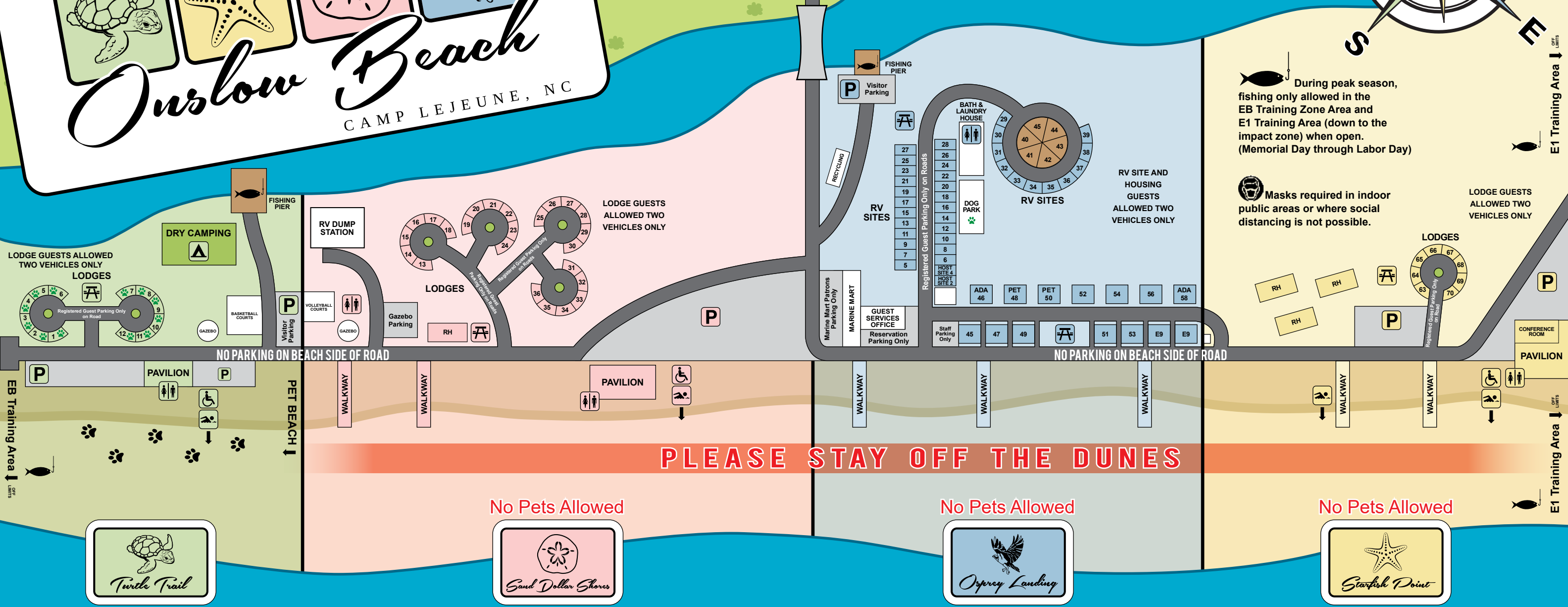

During peak season, fishing only allowed in the EB Training Zone Area and E1 Training Area (down to the impact zone) when open. (Memorial Day through Labor Day)

Masks required in indoor public areas or where social distancing is not possible.

LODGE GUESTS ALLOWED TWO VEHICLES ONLY

LODGE GUESTS ALLOWED TWO VEHICLES ONLY

LODGE GUESTS ALLOWED TWO VEHICLES ONLY

RV SITE AND HOUSING GUESTS ALLOWED TWO VEHICLES ONLY

NO PARKING ON BEACH SIDE OF ROAD

NO PARKING ON BEACH SIDE OF ROAD

PLEASE STAY OFF THE DUNES

No Pets Allowed

No Pets Allowed

No Pets Allowed

Cover Your Tracks, Frequently!



ATLANTIC OCEAN

FLAG WARNING SYSTEM

Safe Swimming Conditions	Medium Hazard	High Hazard	Beach closed for swimming/public use.	Recommended swimming area with lifeguards on duty.	Surfing area, NO swimming.

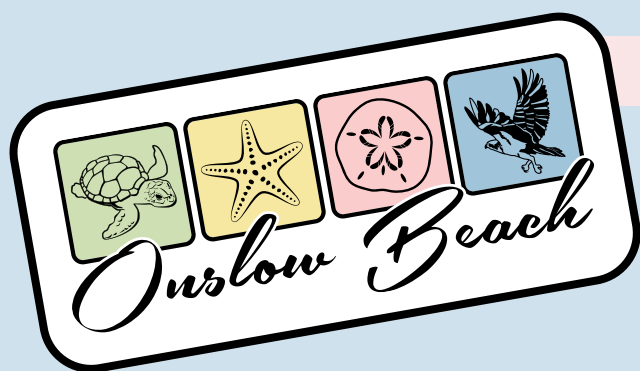

General Information

GENERAL POLICY

- No driving Allowed on the Beach.
- Guests and pets are not allowed on the sand dunes.
- No glass on beach. • No metal detectors. • No climbing on dunes.
- No grilling on decks, tables, or within six (6) feet of any structure.
- Do not place grills or camp stoves on picnic tables.
- Extinguish all coals with water before disposing of them.
- No smoking inside any Onslow Beach facilities or within 50ft. of a building (MCO)
- Bicycle helmets required for all riders per Base Order P5560.2M.
- No open fires permitted.
- At management's discretion, penalty fees may apply for failure to adhere to Onslow Beach regulations & general policy.
- MCCS welcomes people of all abilities to enjoy Onslow Beach. For your enjoyment of the sand and surf, we have a limited number of beach wheelchairs available for free daily use. Please stop by Guest Services for details.

FISHING

Any individuals 16 years or older must purchase a NC Coastal Recreational Fishing License (CRFL) prior to recreationally fishing in any water designated as coastal or joint waters of North Carolina. North Carolina Fishing Licenses may be purchased at Onslow Beach Marine Mart. For current operational hours, visit mccslejeune-newriver.com/marinemarts or call 910.440.6216.

SWIMMING

Guarded swimming areas are provided Memorial Day through Labor Day from 1000-1800 daily. Please swim in guarded areas only. Swimming while under the influence of alcoholic beverages is NOT recommended. Swimming is not permitted from dusk till dawn. Violators will be banned from Onslow Beach.

LAUNDRY FACILITIES

For your convenience, we have a 24-hour coin-operated laundry facility located behind the Guest Services Office, toward the back of the RV Park. (BA 188). Quarters may be obtained at the Guest Services Office or at the Beach Marine Mart.

ALLIGATORS

Be safe in alligator country. Do not approach, harass, or feed alligators. Do not clean fish at or near the waterway. Do not throw fish scraps in the waterway or on the area grounds. Keep small children and pets under close watch when at the waterway, especially at night.

SEA TURTLES

Sea Turtle season is mid-May through October. When walking on the beach at night use only a flashlight with a red filter. Do not disturb turtle tracks. Sea turtles are federally protected under the Endangered Species Act of 1973. It is unlawful to harm, harness, pursue, capture, or kill any endangered species.

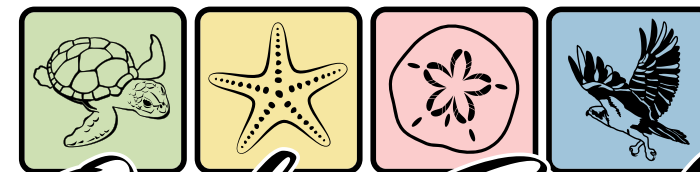

Onslow Beach

Guest Services Office

Guest Services Office: (910) 440-7259 • Reservation Line: (910) 440-7502

MCCSLEJEUNE-NEWRIVER.COM/BEACH

CHECK-IN DATE: _____ CHECK-OUT DATE: _____

Recreation Area Lodging

CHECK-IN: BEGINNING AT 1600

A DoD or VHIC Identification or Privilege Card is required at the time of check-in. Keys will only be issued to a card-holding sponsor or family member over the age of 21 (please note age requirement does not apply to sponsors and spouses).

An authorized patron who has reserved an Onslow Beach facility may have guests; however, responsibility for the facility may not be relinquished to any other person.

CHECK-OUT: NO LATER THAN 1000

Please remove all personal property from the unit (including food) and return keys to the Guest Services Office by 1000. If departing prior to the office opening, please leave keys in the drop box located at the Guest Services Office. **No refunds for early check-outs. Late check-out fees will be applied if keys are not returned on time.**

LODGING UNITS ARE FURNISHED WITH:

Television • DVD Player • Basic Cable • Stove • Refrigerator
Microwave • Toaster • Coffee Maker • Pots/Pans/Bowls
Dinnerware • Flatware • Alarm Clock • Broom/Dustpan
Linens & Blankets • Bath & Dish Towels
(Not exchanged during your stay)

CANCELLATIONS

Reservations cancelled less than seven (7) days prior to check-in date will be charged a processing fee equivalent to one night's stay. A full refund will be granted for cancellations made seven (7) or more days prior to the arrival date.

LATE CHECK-IN

If you are unable to arrive before our office closes, a host camper is available to assist you. The campsite number is posted to the right of our office door and the campground is located directly behind the Guest Services Office.

DUMPSTERS

Please dispose of all trash and general waste in the dumpsters located in the parking area next to the Starfish Point Lodges, beside the Turtle Trail and Sand Dollar Shores Pavilions, and in the back of the RV Park.

RECYCLING

We ask for your assistance in our recycling efforts. There are recycling bins located at each public beach access.

PETS – MCO

Pets are permitted throughout the Recreation Area but are not permitted on any swimming beach. You may take your pet on the beach only at our designated Pet Beach. Pets must be on a leash not to exceed 10 feet at all times. Pets are permitted inside designated Pet Friendly Lodging units for an additional fee. Pets may not be left in unattended vehicles or tied up outside any lodging unit. Failure to follow this policy will result in additional fees and eviction without refund. Exceptions are made for service animals with proper documentation.

PETS MUST BE:

Attended at all times, cleaned up after, kept off of neighboring camp and lodging sites, and leashed at all times.
(leash may not exceed 10 feet)

PERSONAL PROPERTY

MCCS is not responsible for your personal property or equipment. Please ensure the security of your property at all times.

NOISE

Please be considerate of patrons who are utilizing adjacent facilities by keeping noise to a minimum. Unit parties are not permitted in the lodging areas. Quiet hours are observed after 2200. Failure to comply will result in eviction without refund.

Check Out Procedures:

- Please place all towels in the bathroom.
- Place all trash in the trash receptacle outside the unit. Any trash that will not fit in the receptacle should be taken to the nearest trash bin. Excessive trash outside of the receptacle will incur an additional cleaning charge.
- Place the thermostat on 72 degrees (all year).
- Empty all items from the refrigerator (anything left will be disposed of promptly).
- Lock unit upon departure, prior to key turn in.
- Wash all dishes prior to departure. Guests are responsible for keeping kitchen area clean.

Units that are not left in satisfactory condition and/or check out procedures not followed will incur a \$150 extra cleaning charge.

While You Are Here:

- Business Center located at Guest Services – Computer, Wifi, and lending library with books/movies.
- Onslow Beach Marine Mart – located in the middle of the island and carries all your basic needs.
- Movies – \$2 Wednesdays at Base Theaters.
- Bowling Alleys on Camp Lejeune & New River.
- Grab a bite to eat at one of our 20+ eateries!
- Take aim at the Archery/Skeet/Trap or Pistol Ranges.
- Rent a kayak, canoe, or SUP at Gottschalk Marina.
- Hit the links at Paradise Point Golf Course.
- Work out at our Fitness Centers or swim at our indoor or outdoor pools. (DoD ID Card holders *Some fees apply.)
- Rent a kayak, canoe, mountain bike or SUP at Gottschalk Marina.
- Rent yard games from Recreation Equipment Issue.

RV Park & Campground

CHECK-IN: BEGINNING AT 1200

A DoD or VHIC Identification or Privilege Card is required at the time of check-in. Sites will only be assigned to a card-holding sponsor, or family member over the age of 21 (please note age requirement does not apply to spouses).

Patrons must check into the Guest Services Office upon arrival at Onslow Beach and will be offered site selections based on your unit length and availability. Patrons may only use a site assigned by the office, upon arrival. No sites are pre-assigned.

CHECK-OUT: NO LATER THAN 1100

Guests are responsible for the cleanliness of their assigned site. All trash and rubbish shall be placed in the dumpster located next to site #27.

During our non-peak season (November 1-March 31), RV & Tent patrons may stay an unlimited number of nights, based on availability.

Frequently asked questions (FAQs) can be found at mccslejeune-newriver.com/beach.



facebook.com/onslowbeach